



OLM Vector F1 Light - 2015-2021 WRX/STI

Part #: OLMA.70252.1 & 2

Application: 2015-2021 WRX & STi,

Questions? Email us at: support@olm.com

Parts List:

- ① OLM Vector F1 light
- ② Mounting bracket
- ③ Wiring harness
- ④ Mounting bolts (3)
- ⑤ Speed clip (1)
- ⑥ Plastic pop-clip (1)
- ⑦ Taillight adapter harness
- ⑧ Zip ties (4)

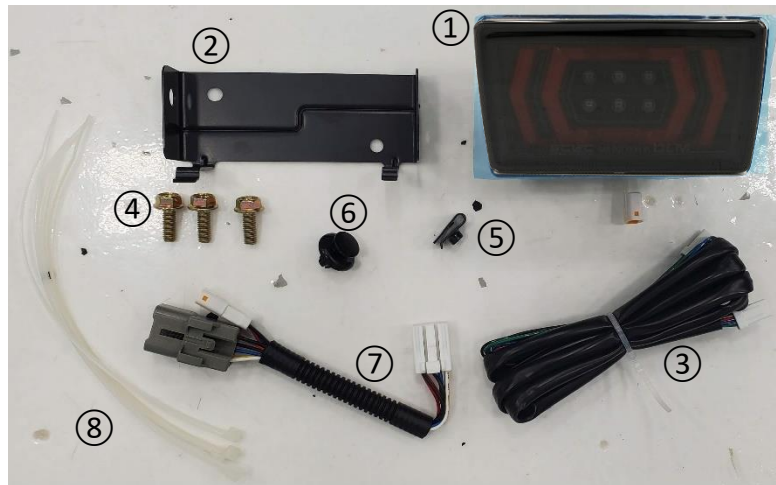

Note: Do not remove the blue film over the lens of your F1 light until the final step of this guide! This film is put in place to keep the lens from getting scratched or marred during the installation process.

Required Tools:

Flathead screwdriver

3/8" ratchet w/ extension

10 mm socket

Lineman's pliers

Optional:

A clean sheet or several towels to set your rear bumper on once it's removed

Note: This install can be done without removing the rear bumper however for the sake of making a complete install guide, that is how it will be shown here.

Installation Instructions:

- 1 – Begin by parking the vehicle on a flat surface. Turn the ignition off and remove keys.
- 2 – Open the hood and trunk
- 2 – Using a ratchet and 10 mm socket, disconnect the positive battery terminal and move away from the battery.
- 3 – Re-enter the vehicle and depress the brake pedal for 10 seconds to ensure any residual power left in the electrical system is dispersed.
- 4 – With the trunk open, begin by removing the 2 large phillips screws shown below

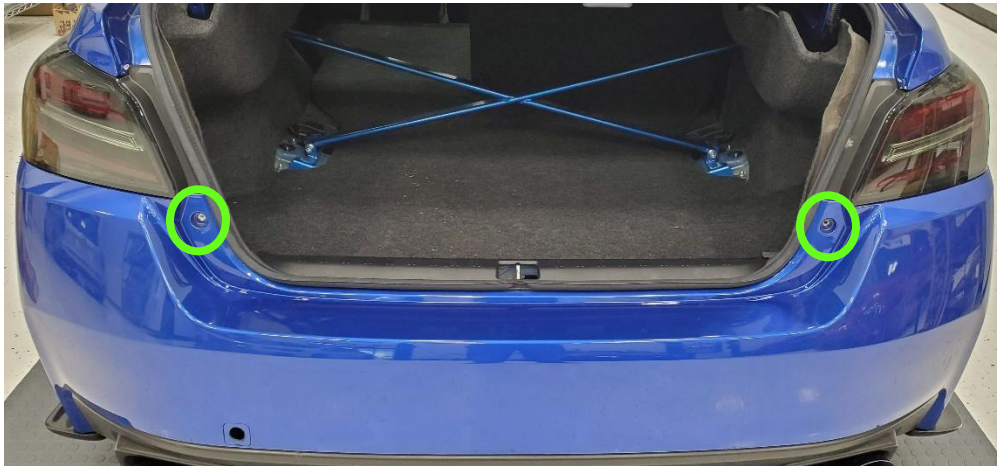

- 5 – Next, move to the rear wheel well. There will be one clip holding the bumper into the wheel well, push the center of the clip to release it and then use a flathead screwdriver to remove. Repeat on the opposite side.



6 – Next, shown below on the underside of the vehicle are 10 pop clips that will need to be removed using a flathead screwdriver. 3 behind each wheel and 4 in the middle of the vehicle



7 – With all the fasteners removed, unsnap the edges of the bumper by grabbing where indicated and pulling outwards.



8 – With the edges free, begin pulling and wiggling the bumper from the center section. There are clips located under the taillights that can be challenging to get free, especially if this is the first time removing the bumper.

9 – With the bumper free from the car, set it down somewhere safely and using a flat head, remove the blank insert from the 4th brake light section of the bumper. You may wish to keep this blank for future use.

10 – Next, take the speed clip, ⑤, and slide it onto the passenger side of the rear brake light cut-out on the bumper, with the threads facing inward, as shown.



11 - Attach the mounting bracket to the bumper using the ratchet and 10 mm socket. The skinny tabs from the mount should be on the bottom as shown. Use one of the mounting bolts, ④, on the passenger side and the single plastic pop-clip, ⑥, on the driver side.

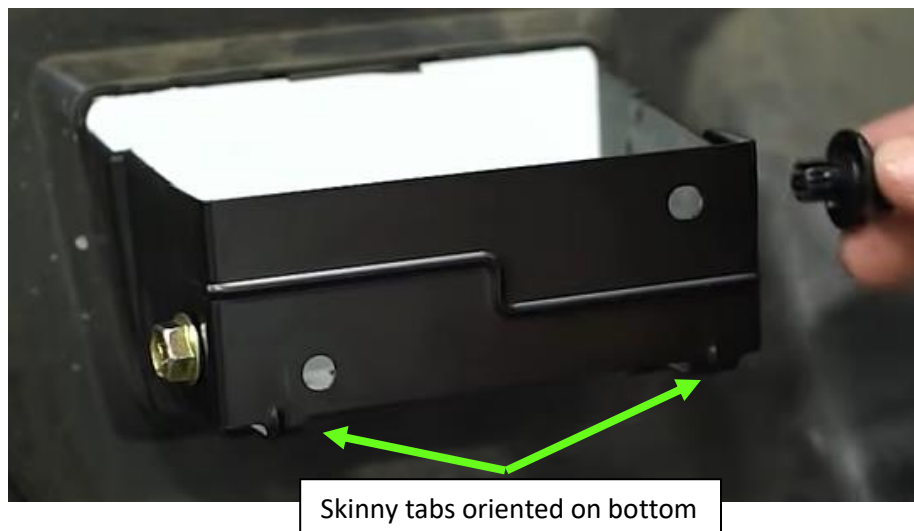

12 – Now, take the F1 light and insert it through the front on the bumper. Secure in place with the wiring harness pointed up using the other 2 mounting bolts, ④.

13 – In the trunk, take out the trunk carpet and spare tire cover and set them aside.

14 – Remove the center trim piece by removing the 3 plastic clips circled below and pulling up.



15 - Now remove the trunk lining behind the driver side taillight, it is held in by the 5 clips shown below.

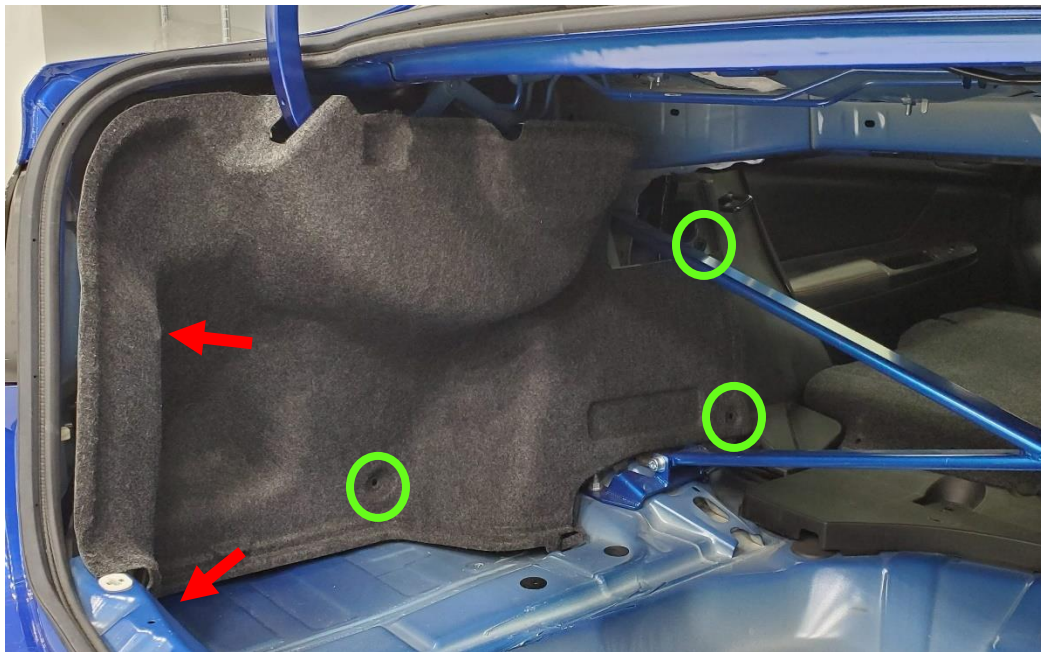

Optional: You can remove the 2 clips noted in red and then bend the trunk liner out of the way to have access to the wiring.

16 – Now remove the rubber plug shown below from the trunk pan. We will use this opening to route the wiring from the taillight to the F1 light.



Optional: If you wish to retain the plug, simply cut a hole or slit into it and then feed the wire through

17 – Take the wiring harness, ③, and feed the white connector through the hole and connect it to the plug from the back of the F1 light.

18 – Back in the trunk of the car, you'll need to unplug the taillight harness, as shown below. Simply depress the tab and pull them apart.

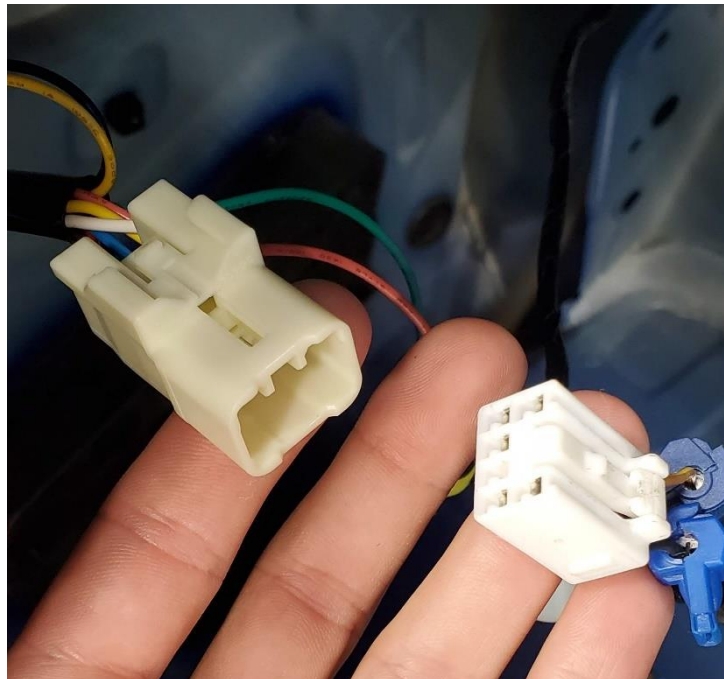

19 – Now, take the taillight adapter harness and connect the gray female connector to the white male connector from the car.

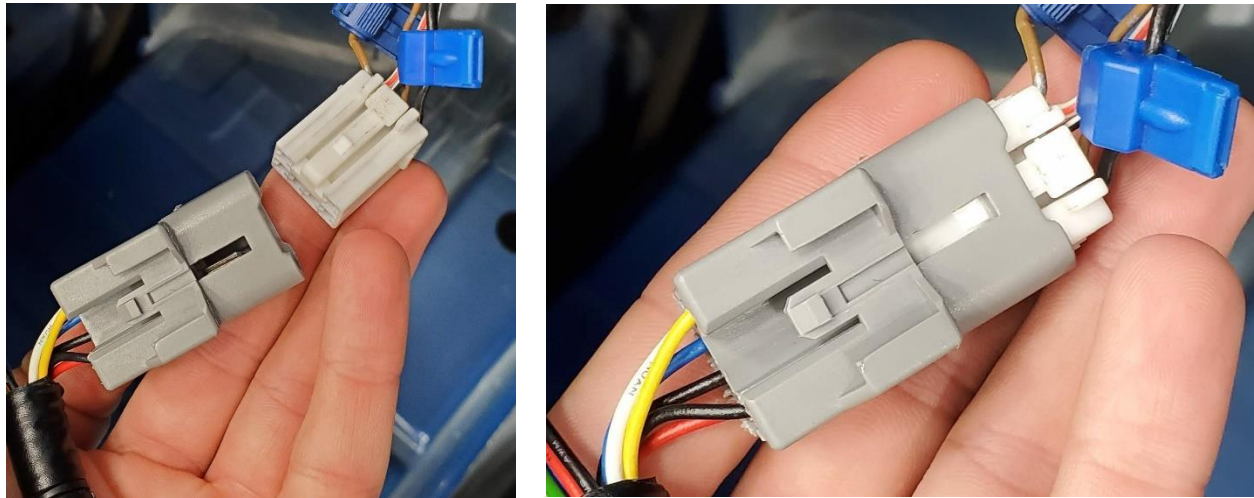

20 – Next, plug the white male plug from the adapter harness into the taillight plug.

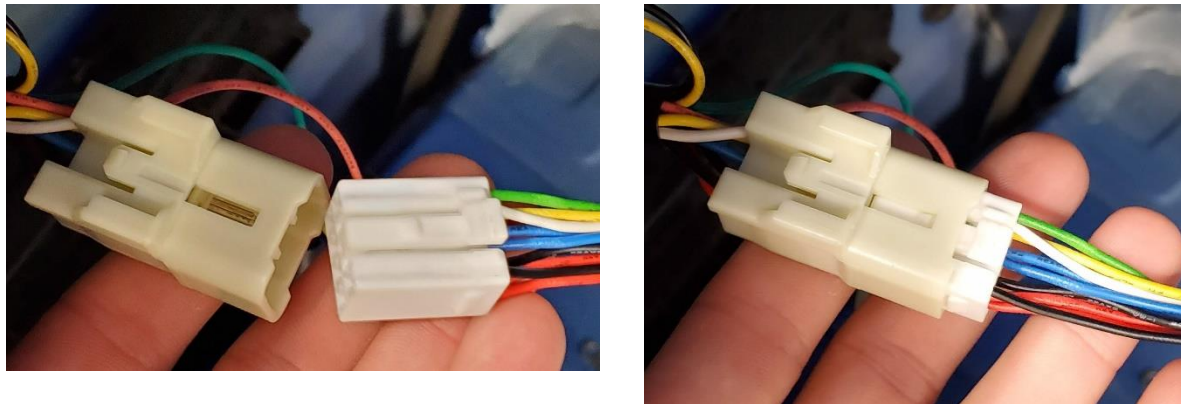

21 – Finally, take the small white connector from the wiring harness, ③, and plug it into the taillight adapter harness.

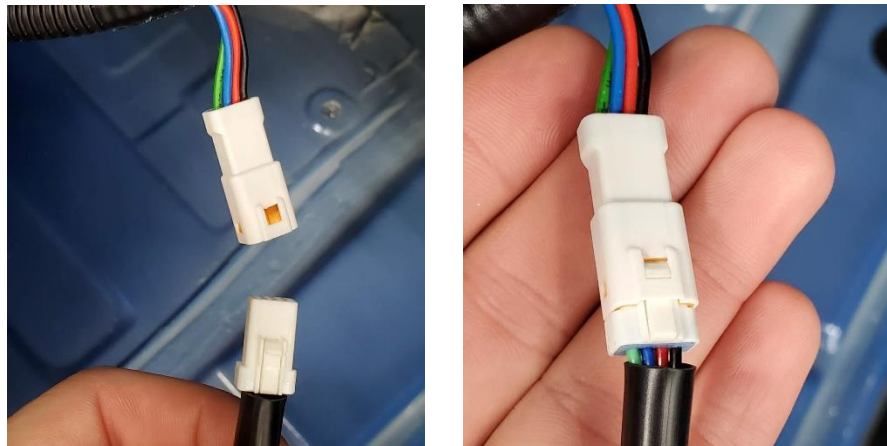

19 – Reconnect the battery and with the help of a friend, test your F1 light before reassembly to ensure it functions as intended. Turn the lights on and the “arrows” should illuminate. When the brake is depressed the center 6 LEDs should become brighter and should strobe. If not please see step 20, to see how to reconfigure the light to strobe if desired.

20 – There are 2 brake functions to choose from. First, strobing which then turns solid when the brake is held down. Second, solid when the brake is depressed and held down. To switch between these 2 modes, simply hold the brake pedal down and cycle the headlights lights all the way on and off 3 times in a row.

21 – Once you have verified that the light is functioning correctly reinstall the rear bumper and trunk interior in the reverse order your removed it. Using the included zip ties, (8), to tie up the wire harness out of the way. Your install is now complete!

Revision Table

V1.0 – Creation 7/27/2022