

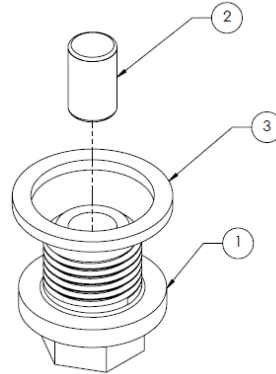

INSTALLATION INSTRUCTIONS

DRAIN PLUG INSTRUCTIONS



BILL OF MATERIALS		
Item #	Description	QTY
1	DRAIN PLUG	1
2	MAGNET (NON-REMOVABLE)	1
3	DRAIN PLUG GASKET	1*

SIZE	PART NUMBER	OEM DRAIN PLUG GASKET PART NUMBER	NOTE
M16X1.5-12	1.10112.1	SUBARU 803916010	ONE TIME USE. INCLUDED WITH PLUG
M18X1.5-12	1.10112.2	SUBARU 17008AA050 TOYOTA/SCION SU00303626	RE-USE OE GASKET FROM STOCK PLUG
M20X1.5-14	1.10112.3	SUBARU 11126AA000	ONE TIME USE. INCLUDED WITH PLUG

DISCLAIMER: PLEASE READ AND MAKE SURE YOU FULLY UNDERSTAND THE INSTALLATION INSTRUCTIONS PRIOR TO INSTALLING FACTION FAB PRODUCTS AND ACCESSORIES. FAILURE TO INSTALL THE PRODUCT CORRECTLY CAN AND WILL RESULT IN IRREVERSIBLE VEHICLE DAMAGE AND OR PERSONAL HARM. IF YOU DO NOT FEEL COMFORTABLE WITH ANY OF THE REQUIRED STEPS, WE HIGHLY SUGGEST TAKING THE VEHICLE TO A QUALIFIED AND EXPERIENCED TECHNICIAN. FAILURE TO UNDERSTAND THE INSTRUCTIONS WHICH RESULTS IN DAMAGE AND OR INJURY IS THE SOLE RESPONSIBILITY OF THE INSTALLER AND ALL FAULT LIES WITH THAT PARTY AND OR INDIVIDUAL AND IS NOT IN ANY WAY, SHAPE OR FORM THE RESPONSIBILITY OF FACTION FAB.

FACTION FAB PRODUCTS ARE SOLD FOR "OFF-ROAD" USE ONLY AND MAY NOT MEET LEGAL REQUIREMENTS FOR OPERATIONS ON PUBLIC ROADS AND HIGHWAYS. WE PUT THE RESPONSIBILITY SOLELY ON THE END CONSUMER/CUSTOMER TO VERIFY THAT THE PRODUCTS DO NOT EFFECT THE VEHICLES ELIGIBILITY TO BE DRIVEN ON PUBLIC ROADS AND HIGHWAYS. INSTALLATION OF FACTION FAB PRODUCTS MAY VOID FACTORY OR AFTERMARKET WARRANTIES.

USE OF PRODUCT IN A NON-CONFIRMED APPLICATION, DISASSEMBLY OF THE PRODUCT, MODIFICATION OF THE PRODUCT, EXPOSING PRODUCT TO CORROSIVE CHEMICALS WILL VOID ANY AND ALL WARRANTY.

1

DRAIN FACTORY FLUID



2

CLEAN THE OIL PAN THREADS AND AREA
AROUND THE PLUG OF ANY DEBRIS



3

INSTALL GASKET ON THE NEW PLUG AND
INSTALL INTO PAN. *SEE NOTE BELOW*



4

TIGHTEN THE PLUG TO FACTORY
SPECIFICATION, AND RE-FILL FLUID



NOTE: M18x1.5-12 DRAIN PLUGS DO NOT INCLUDE A GASKET. A FACTORY DRAIN PLUG GASKET NEEDS TO BE TRANSFERRED FROM THE REMOVED PLUG AND RE-USED ON THE NEW PLUG