

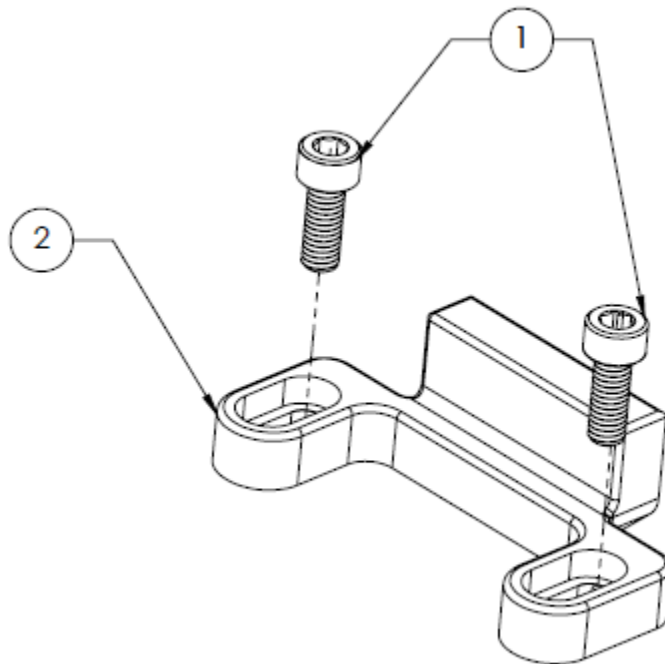

# INSTALLATION INSTRUCTIONS

FFA 1.10001.1

SUBARU SHIFT STOPPER



BILL OF MATERIALS			
Item #	Description	QTY	Part Number
1	M16X16 HEX BOLT	2	2.10001.2.1
2	STOPPER	1	2.10001.1.1

TOOL LIST
RATCHET
10mm SOCKET
EXTENSION
5mm HEX

**DISCLAIMER:** PLEASE READ AND MAKE SURE YOU FULLY UNDERSTAND THE INSTALLATION INSTRUCTIONS PRIOR TO INSTALLING FACTION FAB PRODUCTS AND ACCESSORIES. FAILURE TO INSTALL THE PRODUCT CORRECTLY CAN AND WILL RESULT IN IRREVERSIBLE VEHICLE DAMAGE AND OR PERSONAL HARM. IF YOU DO NOT FEEL COMFORTABLE WITH ANY OF THE REQUIRED STEPS, WE HIGHLY SUGGEST TAKING THE VEHICLE TO A QUALIFIED AND EXPERIENCED TECHNICIAN. FAILURE TO UNDERSTAND THE INSTRUCTIONS WHICH RESULTS IN DAMAGE AND OR INJURY IS THE SOLE RESPONSIBILITY OF THE INSTALLER AND ALL FAULT LIES WITH THAT PARTY AND OR INDIVIDUAL AND IS NOT IN ANY WAY, SHAPE OR FORM THE RESPONSIBILITY OF FACTION FAB.

FACTION FAB PRODUCTS ARE SOLD FOR "OFF-ROAD" USE ONLY AND MAY NOT MEET LEGAL REQUIREMENTS FOR OPERATIONS ON PUBLIC ROADS AND HIGHWAYS. WE PUT THE RESPONSIBILITY SOLELY ON THE END CONSUMER/CUSTOMER TO VERIFY THAT THE PRODUCTS DO NOT EFFECT THE VEHICLES ELIGIBILITY TO BE DRIVEN ON PUBLIC ROADS AND HIGHWAYS. INSTALLATION OF FACTION FAB PRODUCTS MAY VOID FACTORY OR AFTERMARKET WARRANTIES.

USE OF PRODUCT IN A NON-CONFIRMED APPLICATION, DISASSEMBLY OF THE PRODUCT, MODIFICATION OF THE PRODUCT, EXPOSING PRODUCT TO CORROSIVE OR PETROLIUM BASED CHEMICANS WILL VOID ANY AND ALL WARRANTY.

1

REMOVE SHIFT KNOB



2

LIFT CORNER OF SHIFT TRIM BY PULLING UP ON THE CORNER AND REMOVE TRIM SURROUND



3

MARK FACTORY LIMITER PLATE. REMOVE THE TWO 10MM BOLTS

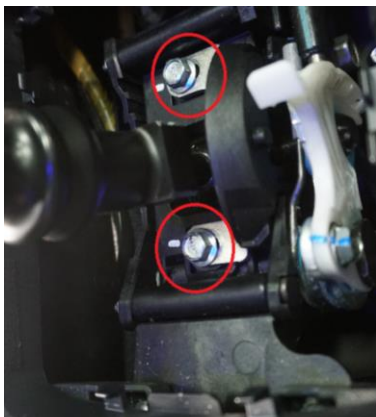

4

LOOSELY INSTALL THE NEW MOUNT WITHOUT TIGHTENING THE HARDWARE

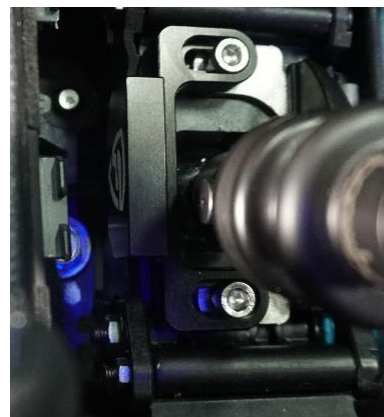

5

PUT THE CAR INTO 5<sup>TH</sup> GEAR AND ADJUST THE PASSANGER SIDE DISTANCE. ENSURE THAT THERE IS A 1/16" GAP BETWEEN SHIFTER AND THE LOCKOUT

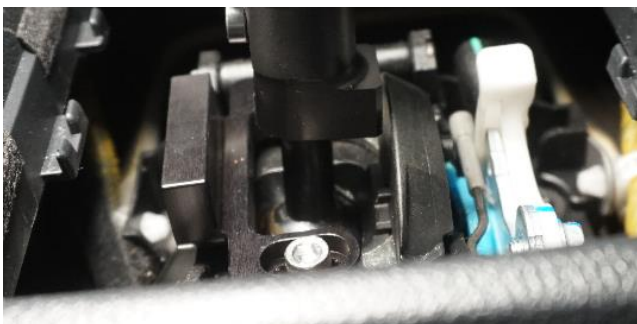

6

PUT THE CAR INTO 1<sup>ST</sup> GEAR AND ADJUST THE DRIVER SIDE DISTANCE. ENSURE THAT THERE IS A 1/16" GAP BETWEEN SHIFTER AND THE LOCKOUT.

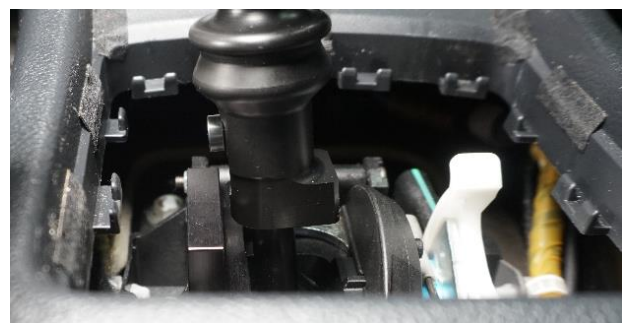

7

TIGHTEN HARDWARE DOWN TO FACTORY SPEC. SHIFT THROUGH ALL GEARS AND ENSURE THAT THERE ARE NO ENGAUGEMENT ISSUES.



8

RE-INSTALL SHIFT TRIM, SHIFT KNOB, AND TEST DRIVE VEHICLE TO CONFIRM GEAR ENGAUGEMENT TO COMPLETE THE INSTALL