

ARB COMPRESSOR MOUNTING KIT

Installation Instructions

Please read all instructions before proceeding with installation.

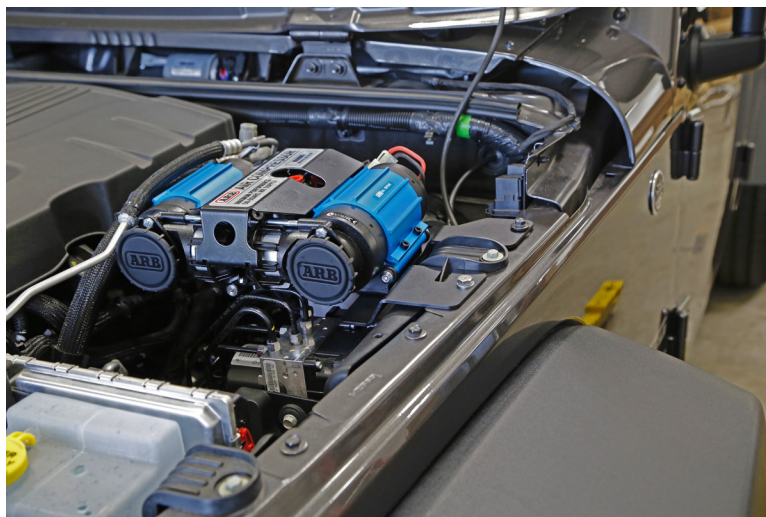

Warranty Information: This item is sold without warranty expressed or implied. The user assumes the risk of the product's ability to protect the user from injury or death. The effectiveness and longevity of this product are in direct relation to the manner in which it is installed, used and maintained. The user assumes all risk. The entire risk with the performance of this product is with the purchaser. Working on your vehicle can be a dangerous activity, and if you are unsure of what you are doing, please leave mechanical or safety critical work to a skilled mechanic. We take no responsibility for the incorrect use or installation of this product.

Tools & Tips

These are the recommended tool for ease of installation. You may use any other tool that will help make the installation process easier or different versions of the same tool.

Tools List

Drill
17/32" Drill Bit
10mm, 13mm, 14mm sockets or wrenches
Ratchet
9/64" Allen Wrench



Important Note

Before installing the ARB Compressor Mounting Kit you must install the ARB Compressor onto the Mount. However, these instructions are shown without the compressor to better illustrate the installation process.



These installation instructions contain all the steps for installing the compressor mount. Please read and follow all instructions in order.

Pieces & Parts

Item	Part Number/Description	Qty
1	Bolt	1
2	Bolt	1
3	Tapered Bolt	1
4	Nut	1
5	Nut	1
6	Rev Nut	1
7	Washer	2
8	Star Washer	1
9	Bracket	1
10	Angle Bracket	1

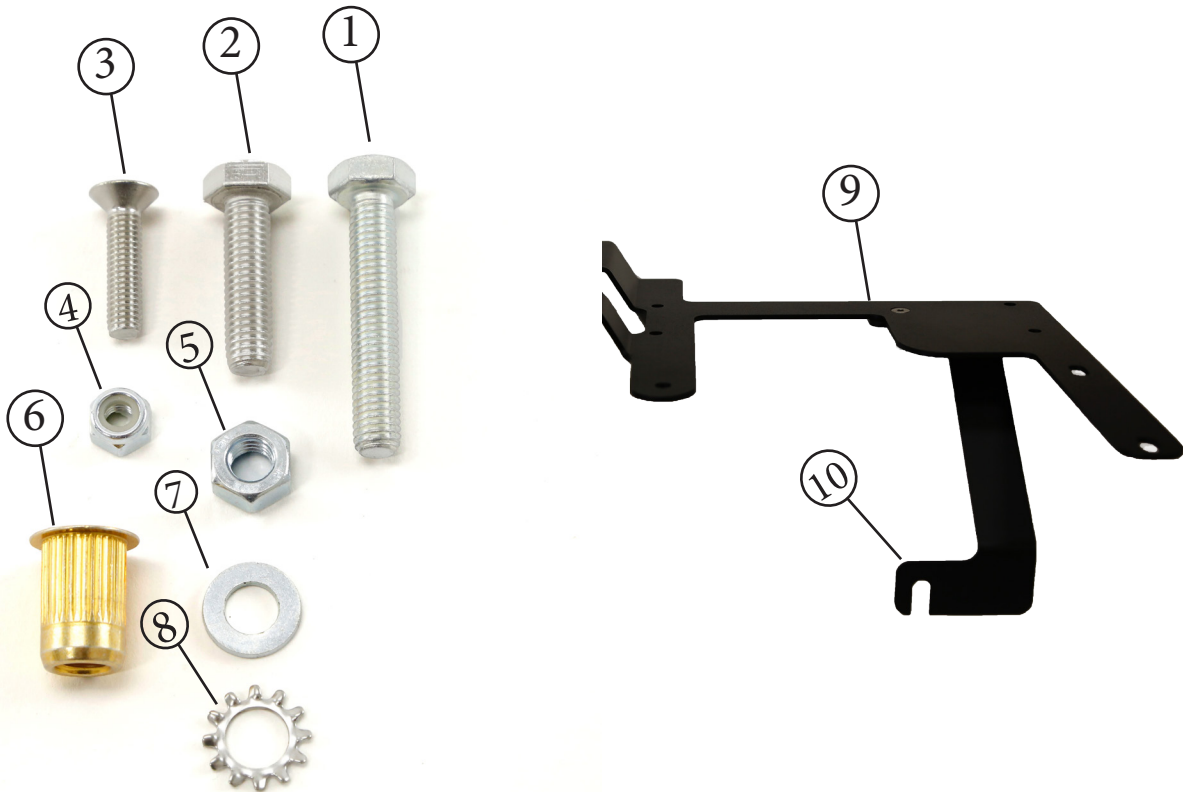

Installation

1. Attach the Angle Bracket to the Compressor mount in the tapered bolt location (should look like picture when attached), with bolt and washer. Use 9/64" Allen Wrench to tighten the bolt.



2. Install the ARB Twin Compressor to the bracket.



3. Unplug and remove the horn. It is recommended that you mount the horn on the bracket at this point, but it can be done later as well.

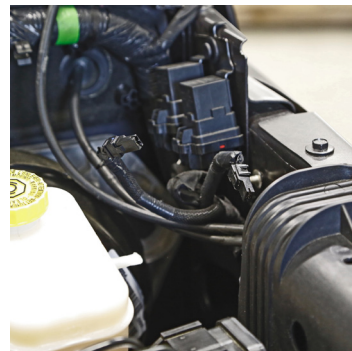
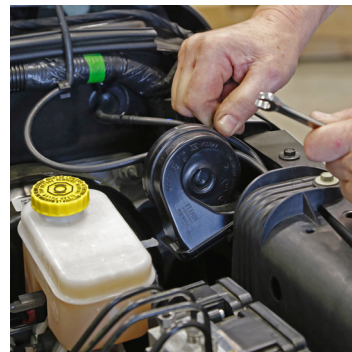

Installation

4. Remove the factory bolt using a 10mm socket. 1st bolt/hole on the top.



5. Loosen the Master Cylinder nut closest to the passenger side, using a 13mm socket and short extension. DO NOT REMOVE!

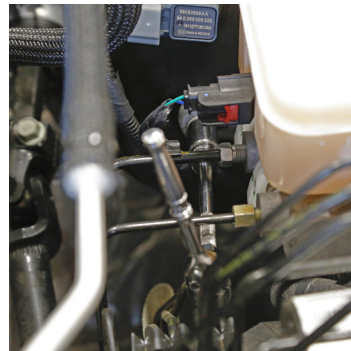
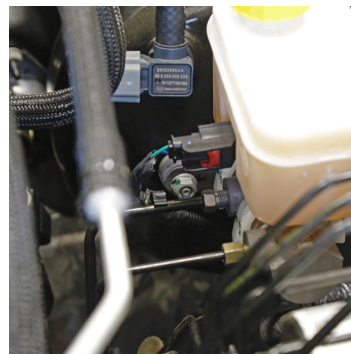

6. Using the 17/32" drill bit, drill in the 2nd hole to widen it. WEAR EYE PROTECTION! Make sure there are no wires under the hole that you could possibly drill into and use a sharp drill bit.

a. Deburr (file) the hole and put some touch up paint in it to prevent rusting.



Installation

7. Put the provided bolt, rev nut and washer together.



8. Put the rev nut in the hole that you drilled out, so it is flush with the top, tighten the nut while holding the bolt to compress the rev nut, then remove nut and bolt.



8. Using the slotted end of the angle bracket, slide the angle bracket onto the Master Cylinder Bolt to fit around it (the bolt you loosened inside the manifold). And line up the holes on the top of the bracket with the 1st and 2nd (rev nut) holes on top.



This slot slides around the loosened bolt →

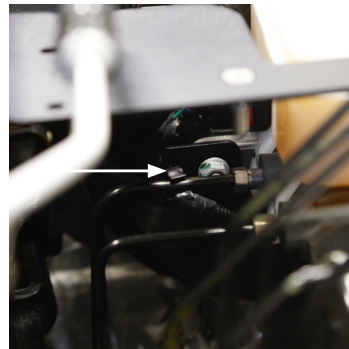

9. Tighten the two bolts on top. Tighten the Master Cylinder Bolt to 13 ft lbs. Make sure you are happy with everything and tighten all bolts.



10. Remount the horn to the bracket, if you didn't do it earlier, and plug it back in.